

Currents

BWSC News

Nov/Dec 2020

The traditional celebrations that occur this time of year may look different as a result of COVID-19. Please celebrate safely, and enjoy the holidays in good health.

What is FOG?

As many of us are baking, roasting and preparing seasonal meals there is one rule that every cook should remember:

Don't dump Fats, Oils, or Grease (FOG) down the drain! Instead, **Can the Grease!**

Where does FOG come from? FOG is found in many food products such as:

- Cooking oil
- Butter and margarine
- Lard
- Sauces
- Meat fat
- Dairy products



FOG is an unavoidable part of cooking but knowing how to dispose of FOG is key. Excess Fats, Oils, and Grease should never be poured down the sink, or flushed down the toilet. FOG that's poured into the sink or toilet will harden in the pipes and cause backups in your plumbing and Boston's sewer system.



Disposing of FOG is easy

All you need to do is **Can the Grease!**

After cooking, let FOG cool in the pan. Once cooled, pour or scoop FOG into a can, cover the can with a BWSC Grease Lid and store it in the freezer. When the can is full, remove the lid for reuse, and put the can into the trash on your regular trash collection day.



Boston residents can request a FREE BWSC Grease Lid! Call BWSC at 617-989-7599, or request one online at www.bwsc.org.





BWSC Community Outreach

November 28 is Small Business Saturday. BWSC lends its support to the City of Boston Main Streets by donating free packets that include a grease lid. Whenever you choose to shop, stop by any of the 20 participating Main Streets offices and pick-up a free packet courtesy of BWSC. Visit the main streets page at www.boston.gov for information on your local main streets district. Thank You for shopping locally.

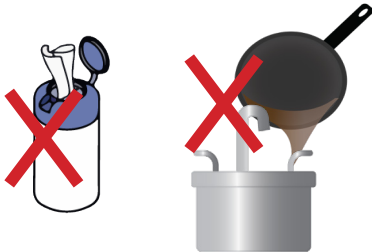

Sanitary Sewer Overflow Prevention

A Sanitary Sewer Overflow (SSO) is an unintentional discharge, spill or release of untreated sewage into the environment or a property. The overflow resulting from these sewer backups can cause damage to a property and pollute the environment.

To Help Prevent Sanitary Sewer Overflows, Please:

- **Keep Wipes Out of pipes:** There are many disposable wipes that claim to be “flushable” and “sewer safe.” However, these wipes do not break down as they travel through pipes and into the sewer system. Wipes can create clogs in both household plumbing and the public sewer system and result in SSOs.
- **Fats, oils, and grease (FOG) can cause blockages in sewer pipes and lead to SSOs.** Proper Disposal of FOG can help to prevent SSO. “Can the Grease!”



Don't Forget to Scoop the Poop!

Catch Basins connect to storm drains that discharge runoff without treatment to the nearest waterway. Dumping pet waste into a catch basin pollutes the same waterways that we utilize for recreational purposes. As with other refuse, the proper place to dispose of pet waste is in the trash. Pet waste is harmful to our waterways.

Convenient Ways to Pay while staying Safe

- **Online:** Visit the My Account page to make electronic payments using your checking/money market account, debit card or credit card. BWSC accepts MasterCard, VISA, and Discover.
- **By Phone:** Customer service representatives are available to answer questions at 617-989-7800.
- To check your balance or make a payment by phone, please call 844-470-5881.
- **In the Mail:** Mail check or money order directly to:
Boston Water and Sewer Commission
980 Harrison Avenue
Boston, MA 02119

